

# MODEL: PROTRUAR

12V-2.0HP

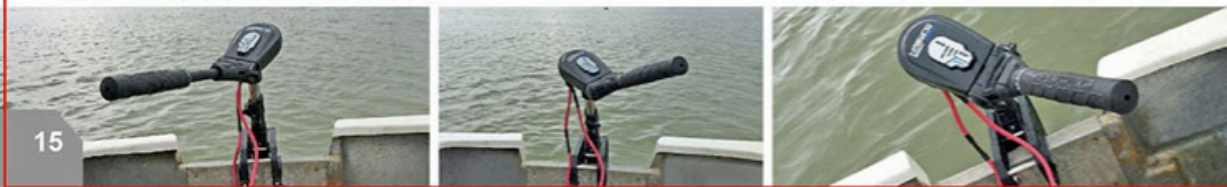

Actual model may vary from image!



## SPECIFICATIONS

**Shaft Power:** .....  
2HP,  
**Comparable petrol outboards (thrust):**

3HP,  
**Peak Thrust in Lbs:**  
85Lbs

**Max Voltage:**  
DC 12V

**Power - Max:**  
720W,

**Amp - Max:**  
60A

**Depth Adjustment:**  
Depth collar

**Prop Type:**  
3blade prop / 10.7inch diam

**Prop Speed at Full Power:**  
Max. 1150 rpm underwater

**Battery Type Required:**  
1x120AH Deep Cycle

**Steering:**  
360 degree control

**Decibel Level (db):**  
55db

**Weight (N.W.):**  
10.3kg

**Shaft Type:**  
Stainless Steel

**Shaft Length:**  
900mm

**Colour:**  
Black

**Max Boat Length (Suggestion):**  
6.5m

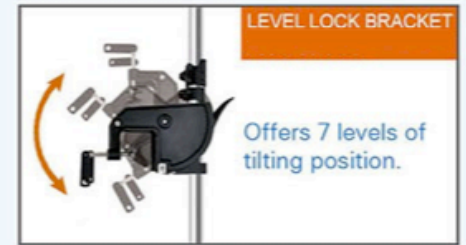

The Protruar is equipped with an innovative and powerful 110 lbs thrust from a 12V brushless motor, providing excellent propulsion for a wide range of boats and waterways. Equipped with step-less adjustable speed control and a magnetic safety lanyard. This motor can easily be tilted in and out of the water and the trim height is adjustable by way of a quick lock mechanism, so you can motor in almost any level water. It features an LED battery level indicator, and is suitable for both salt and fresh water use.